



These are original photos of sailing catamaran Clione



## SIMPLE SAIL

CATAMARAN FLEET IN MONTENEGRO

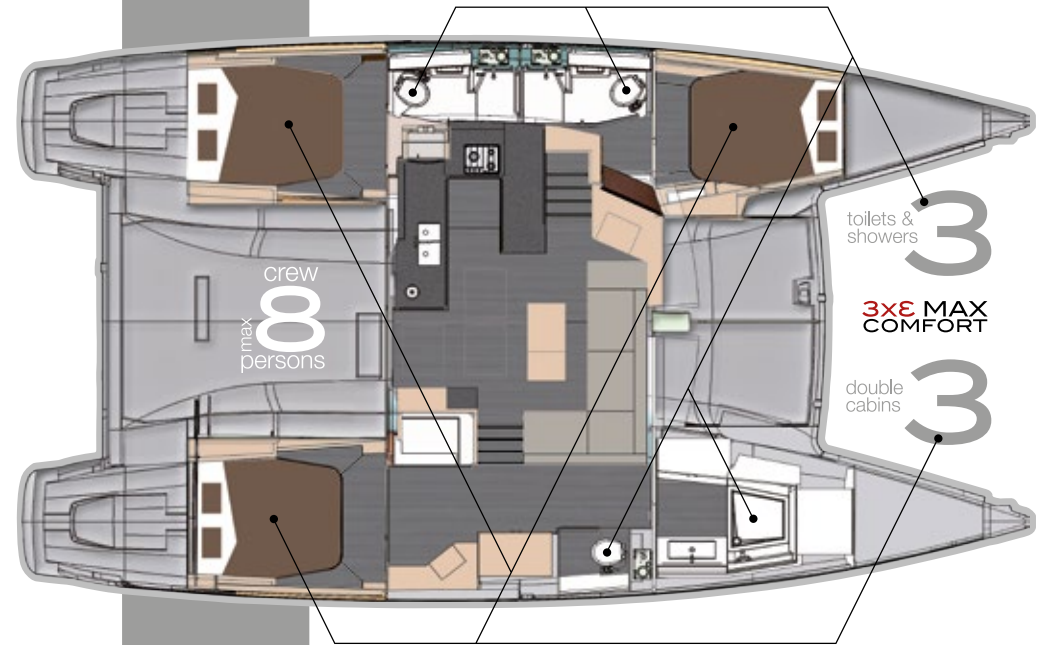

# 44 CLIONE

FOUNTAINE PAJOT HELIA 44 2015

<b>Year of Build</b>	2015	<b>Draft</b>	1,16 m
<b>Manufacturer</b>	Fountaine Pajot	<b>Water Tanks</b>	2x375 l
<b>Design</b>	Berrett-Racoupeau	<b>Fuel Tanks</b>	470 l
<b>Interior Layout &amp; Design</b>	Racoupeau Design	<b>Holding tank</b>	3x45 l
<b>Length</b>	43,5 ft / 13,30 m	<b>Light Displacement</b>	16 535 kg
<b>Length Overall</b>	13,30 m	<b>Bow Thruster</b>	NO
<b>Hull Beam</b>	7,40 m	<b>Engine</b>	Volvo 2x55 hp
<b>Cabins</b>	3 + 2 for crew	<b>Berths/Toilets</b>	6 + 2 crew / 3
<b>Sails</b>	Full batten main sail 70 m <sup>2</sup> , Furling genoa 45 m <sup>2</sup>		
<b>Deck</b>	Fenders, Mooring lines, Bimini, Cockpit cushions, Cockpit Shower, Cockpit speakers, Cockpit table, Dinghy, Anchor windglass, Self tailing winches, 1 electric winch, Snorkling gear set, Solar panels.		
<b>Navigation</b>	Navigation B&G Zeus, Adriatic sea pilot, Autopilot, Binoculars, Depth sounder, Full sets of charts, GPS, Plotter, Speed log, VHF with AIS, Portable VHF, Windex, Radar		
<b>Safety</b>	Liferaft, Lifejackets, First aid kit, Fire extinguisher, Fire plant, Thermo protective aid, EPIRB		
<b>Additional Equipment</b>	Audio, Hot water, Electric toilets, Galley, Electric Fridge, Inverter 12V / 220V Sockets, Hairdryer, Iron, Watermaker 180 lt/h, Air condition, Diesel generator, Electric kettle, 2 crew cabins.		

