

These are original photos of sailing yacht Twist

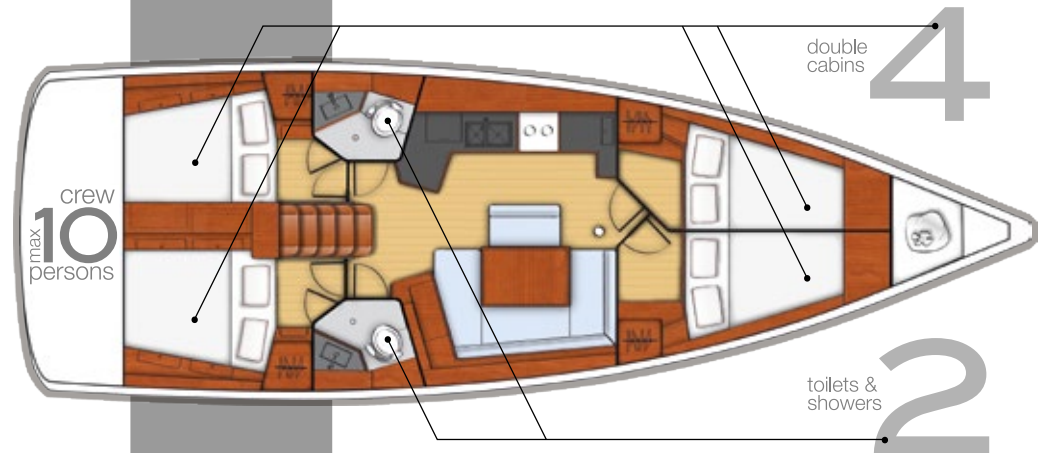

SIMPLE SAIL

SAILBOATS FLEET IN MONTENEGRO



45 TWIST

BENETEAU OCEANIS 2015

Year of Build	2015	Draft	2.27 m
Manufacturer	Beneteau	Water Tanks	530 l
Design	Finot-Conq Architectes	Fuel Tanks	200 l
Interior Layout & Design	Nauta Design	Holding tank	80 + 64 l
Length	45 ft / 13.50 m	Light Displacement	10 549 kg
Length Overall	13.94 m	Bow Thruster	YES
Hull Beam	4.50 m	Engine	Yanmar 54 hp / SailDrive
Cabins	4	Berths/Toilets	10 (8+2) / 2

Sails	Full battened main sail 51 m2, Furling genoa 49 m2
Deck	Fenders, Mooring lines, Bimini, Cockpit cushions, Cockpit Shower, Cockpit speakers, Cockpit table, Dinghy, Anchor windlass, Self tailing winches, Snorkling gear set, Sprayhood, Swimming ladder, Additional Anchor, Bath platform, Bow Thruster.
Navigation	Multifunction display B&G 7 (2), Multifunction touchscreen display B&G 12, Adriatic sea pilot, Autopilot, Binoculars, Depth sounder, Full sets of charts, GPS, Plotter, Speed log, VHF with AIS, Portable VHF, Windex.
Safety	Liferaft, Lifejackets, First aid kit, Fire extinguisher, Fire plant, Thermo protective aid, EPIRB
Additional Equipment	Audio, Hot water, Electric toilets, Galley, Electric Fridge, Invertor 12V / 220V Sockets, Hairdryer, Iron, Gas stove, Electric kettle.

